

# PLASTIC PALLET/SKID - PLP2-4840-YELLOW

APPROX WEIGHT: 38 lbs.  
DOES NOT INCLUDE WEIGHT OF POWER OR PACKAGING!!!

\*\*\* ANY ADDITIONS, DELETIONS, OR OMISSIONS MUST BE CORRECTED ON THIS DRAWING AS THIS DRAWING WILL BE CONSIDERED ALL INCLUSIVE \*\*\*  
ALL GRAPHICS PROVIDED ARE FOR REFERENCE ONLY. IF CERTAIN DIMENSIONS ARE CRITICAL PLEASE VERIFY THOSE DIMENSIONS WITH YOUR SALESPERSON

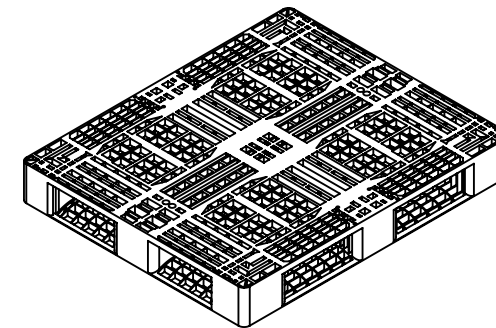
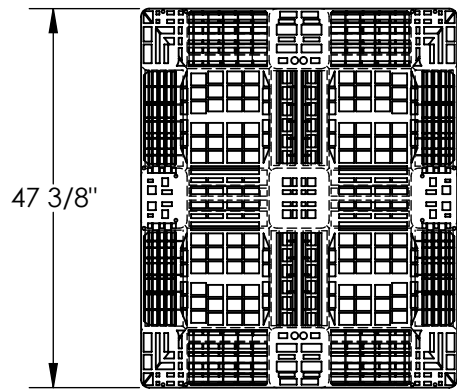

HOLE PATTERN MAY VARY

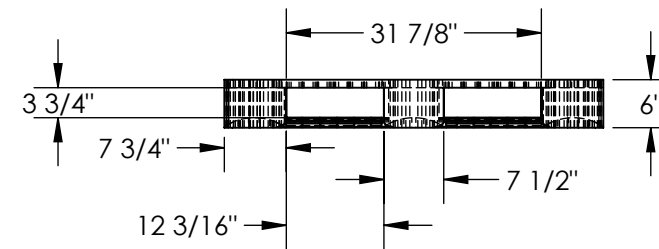
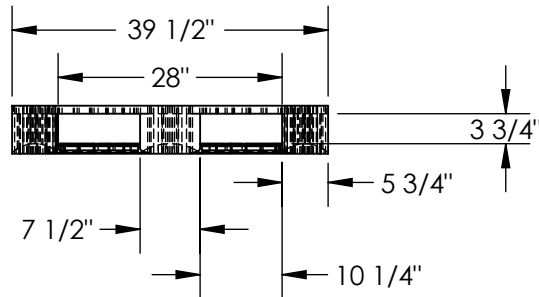

## STANDARD FEATURES

- MODEL NUMBER IS PLP2-4840-YELLOW
- OVERALL WIDTH IS 47 3/8"
- OVERALL LENGTH IS 39 1/2"
- OVERALL HEIGHT IS 6"
- FLOOR (STATIC) WEIGHT CAPACITY: 6,600 LBS
- FORK (DYNAMIC) WEIGHT CAPACITY: 2,200 LBS
- UNSUPPORTED PALLET RACK WEIGHT CAPACITY: NOT RATED
- FORK OPENINGS (W X H): 10 1/4" X 3 3/4"  
12 3/16" X 3 3/4"

**A  
P  
P  
R  
O  
V  
A  
L**

I, THE UNDERSIGNED, AGREE THAT THE PRODUCT AS REPRESENTED SATISFIES DESIGN AND DIMENSION REQUIREMENTS. I ALSO ACKNOWLEDGE MY DUTY TO CONFIRM PRODUCT AND INSTALLATION COMPLIANCE WITH ALL APPLICABLE FEDERAL, STATE AND LOCAL REGULATIONS AND STANDARDS.  
**ALL SPECIAL UNITS ARE NON-RETURNABLE**  
[ ] As drawn [ ] As marked

Signed: \_\_\_\_\_ Date: \_\_\_\_\_

**LEAD TIME WILL START UPON RECEIPT OF SIGNED APPROVAL DRAWING**

DISTRIBUTOR'S NAME:		P.O.#
VESTIL MANUFACTURING		X
DRAWN BY: DEY		W.O.#
DATE: 11/23/10		X
REFERENCE: X	SCALE: 1:24	SALES: X
QUOTED LEAD TIME: X	QUOTE #	FILE NAME:
	X	30-007-228

## SPECIAL FEATURES

NONE